

Notes:
 - Do not scale from this drawing. Use figured dimensions in all cases.
 - Verify dimensions on site and report any discrepancies to the Architect immediately.
 - This drawing is to be read in conjunction with the Architect's Specification.
 - © This drawing is copyright and may only be reproduced with the Architect's permission.

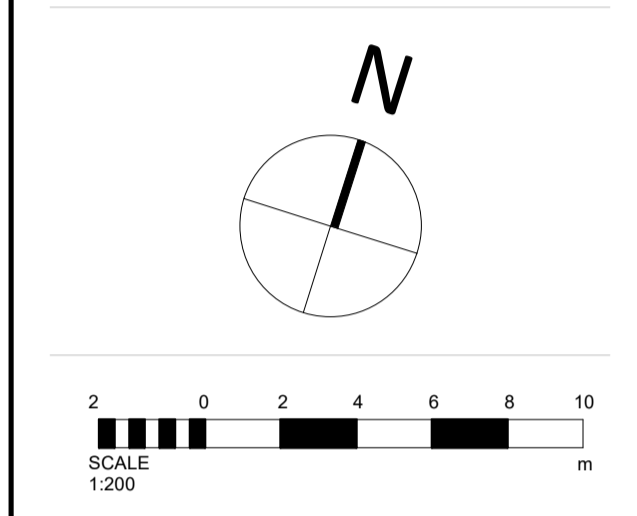
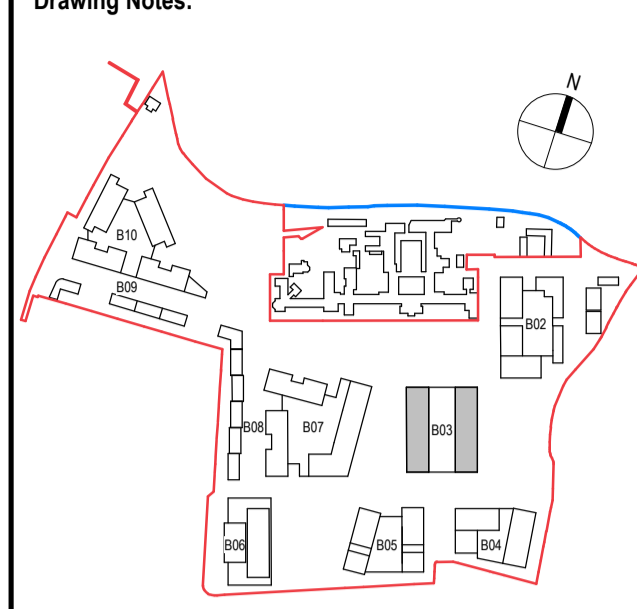

- Planning Legend**
- Site Boundary
 - Residential Entrance
 - Service Entrance
 - 1B2P
 - 2B3P
 - 2B4P
 - 3B5P
 - Amenity
 - Restaurant
 - Retail

| Rev. | Date | Drawn | Details of Issue / Revision |
|--------|-----------|-------|------------------------------|
| P3-S-1 | Sept 2024 | KP | Part 10 Planning Application |

Issues & Revisions

Darity Mills,
 Darity Road
 Dublin 6,
 D06 Y0E3
 T: +353 (0)1 498 7000
 W: www.reddyarchitecture.com
 E: info@reddyarchitecture.com

Applicant Details:
Dún Laoghaire-Rathdown County Council

Agent Details:
Land Development Agency

Project Details:
**Proposed Part 10 Residential Development,
 Dundrum Central Development,
 Dundrum Road,
 Dublin 14**

Drawing Title:
Block 03, Lower Ground Floor, GA Plan

| | | |
|---------------------------------|-----------------------------------|---------------------------------|
| Job No. P19-233D | Sheet Size A1_Landscape | Scale @A1: 1 : 200 |
| Issue Date: Sept 2024 | Drawn By: K. Potocka | Reviewed By: R. Quinn |

Status: **P3** Purpose of Issue: **Part 10 Planning Application**

| | |
|---|---------------|
| Project - System - Spatial Zone - Level - Type - Originator - Role - Number | Revision |
| DCD-02-B03-B01-DR-RAU-AR-1350 | P3-S-1 |